



## Headstone Road, HA1

**£280,000**

A well-presented ground floor flat with private entrance, offering two double bedrooms, a bright reception room with outdoor access, a modern kitchen, and a stylish bathroom. The main bedroom features a bay window and fireplace with a private rear garden.

Just 0.3 miles from Harrow-on-the-Hill station, offering Metropolitan and Chiltern Rail links into Central London. Close to Harrow town centre with shops, cafés, restaurants and amenities, plus nearby schools including Norbury School and The Jubilee Academy.

- Two Double Bedrooms • Ground Floor • Private Garden •
- Private Entrance • No Onward Chain • Great Transport Links •

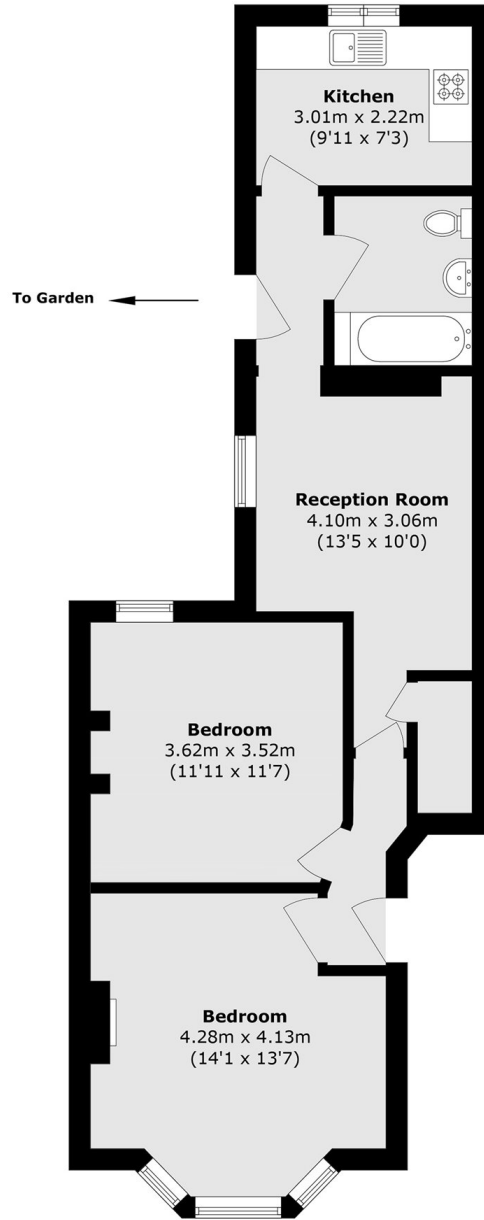

Total area (approx.): 59.9 sq. m (644.8 sq. ft)

David Conway  
020 8422 5222

Energy Rating: C We aim to make our particulars both accurate and reliable. However they are not guaranteed; nor do they form part of an offer or contract. If you require clarification on any points then please contact us, especially if you're travelling some distance to view. Please note that appliances and heating systems have not been tested and therefore no warranties can be given as to their good working order.